

Emergency Department (A&E) and Emergency Floor

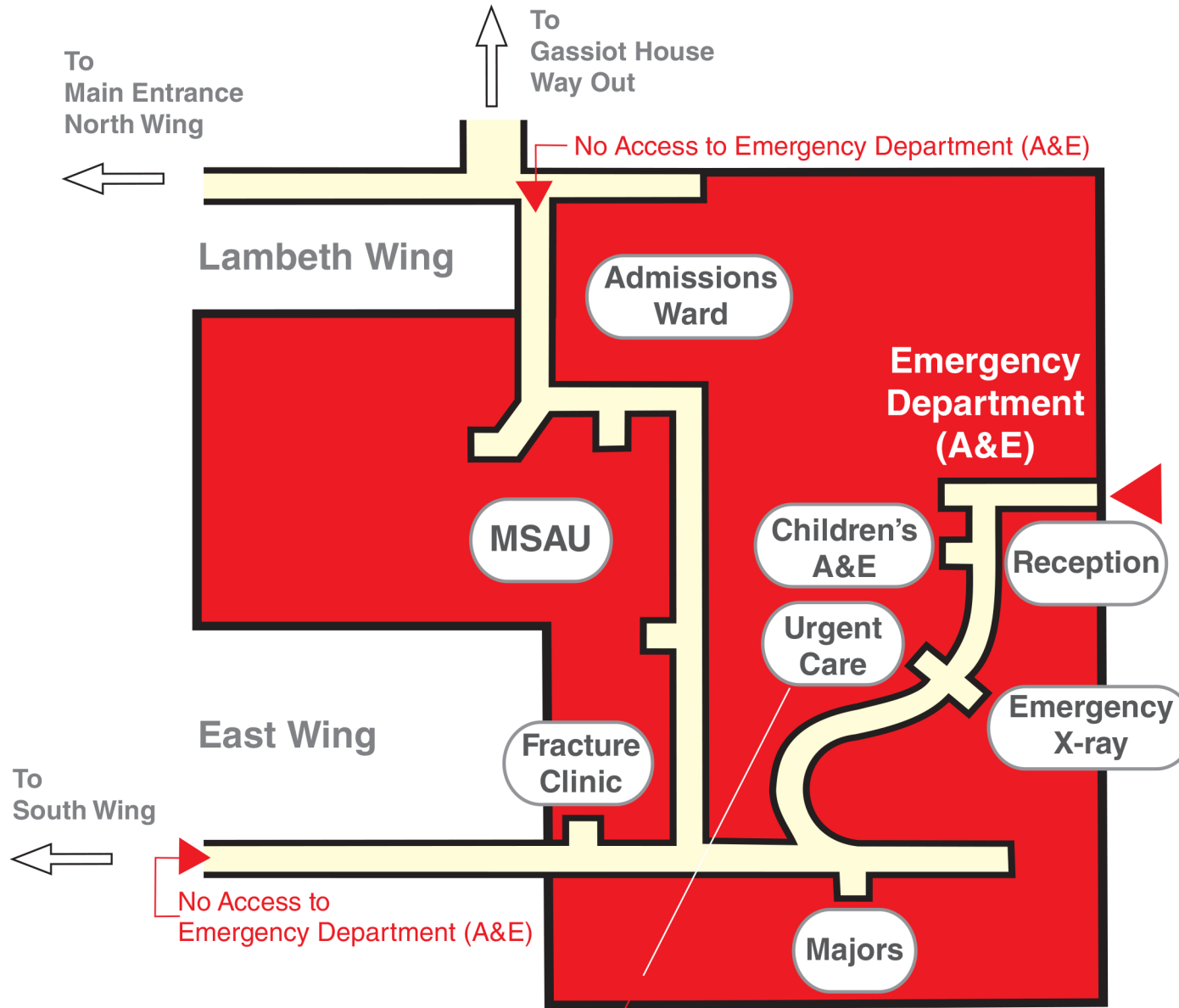

For 'Urgent Care' please register in Emergency Department (A&E) first

Ground Floor Plan

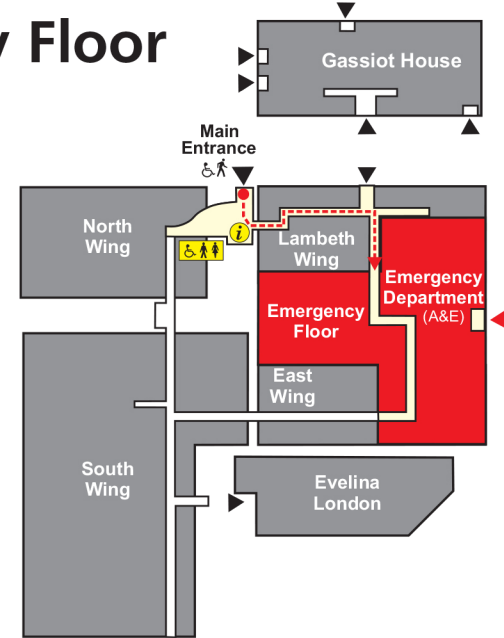

Key

- Building Entrances
- Route to Wing
- Pedestrian Access
- Disabled Access
- Main Corridors
- Information
- Lifts
- Stairs
- Toilets
- Directions to Wings