

# South Wing - 1st Floor

Access only via these lifts:

## Lift B only

### Children's Services

Neurosciences

### Outpatients

Rare Diseases Centre

### Services

Chapel

Information Governance

Spiritual Care

## Lift C only

### Children's Services

Cleft Services

### Outpatients

Medical Photography

Mycology

## Lift D only

### Children's Services

Sleep and Respiratory Centre

Snow Fox

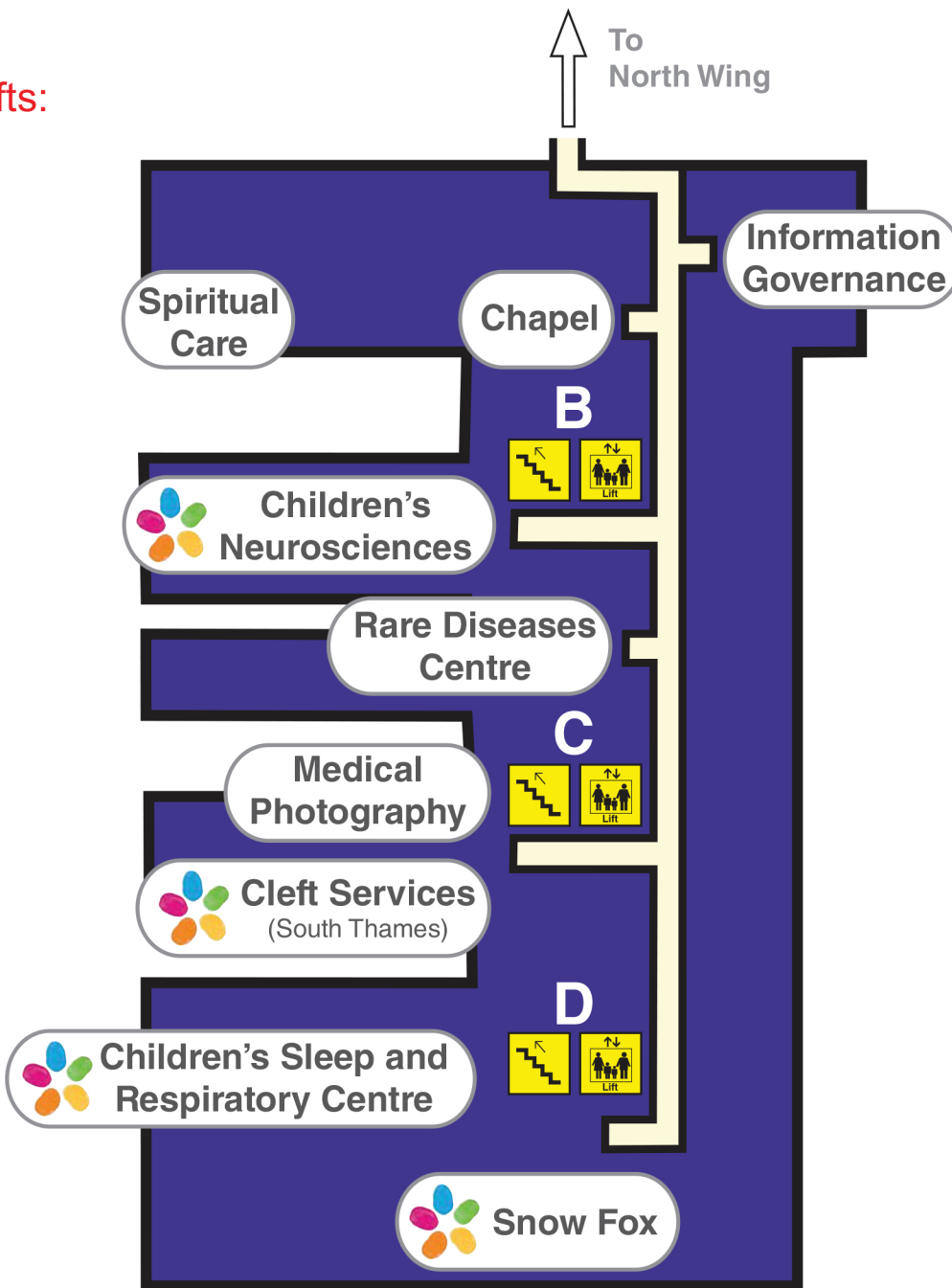

## Ground Floor Plan

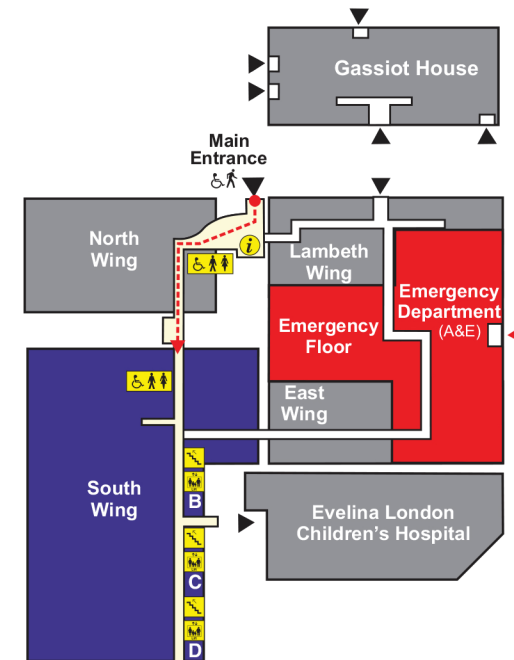

## Key

- Building Entrances
- Route to Wing
- Pedestrian Access
- Disabled Access
- Main Corridors
- Information
- Lifts - B, C, D
- Stairs
- Toilets
- Directions to Wings